

## Lifting station Minilift S KTP 300, resistant, Floor slab, tileable

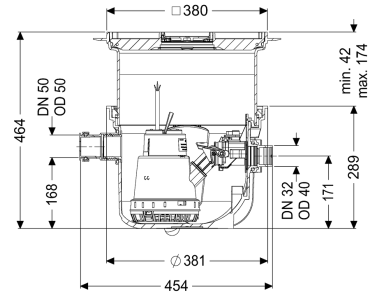

### Article information

Item no.: 280570XC  
 GTIN: 4026092093504  
 Price group: 20

### Advantages

- Space-saving installation in the floor slab with integrated drainage function
- System ready to plug in
- Easy tool-free maintenance

### Description

The ready to plug in small lifting station for faecal-free wastewater is suitable for wastewater drainage of individual sanitary appliances. The submersible pump with float switch can be removed easily with the help of one-handed closures. The collection tank made of polymer (PE) has an open pump tank and is resistant to aggressive wastewater. The system for installation in the floor slab is preassembled for final installation on site.

#### Variant

Type of system:  
 Resistant:

Single unit  
 Resistant to saline media, wastewater from water softening systems and wastewater containing condensate from heating systems

Pump control:  
 Backflow preventer:

Float switch  
 integrated

#### General characteristics

Colour:  
 Standard:  
 Type of wastewater:  
 Installation situation:  
 Delivery state:

grey  
 EN 12050-2  
 without sewage  
 floor slab installation  
 Installation-ready (connection parts must be connected on site)

ATEX:

no

#### Dimensions

|                               |                                     |
|-------------------------------|-------------------------------------|
| Net weight:                   | 10,8 kg                             |
| Gross weight:                 | 11,8 kg                             |
| Installation depth:           | 330 - 460 mm                        |
| Type of height adjustability: | vertically adjustable upper section |
| Length:                       | 460 mm                              |
| Width:                        | 380 mm                              |
| Packaging dimension:          | length                              |
| Packaging dimension:          | width                               |
| Packaging dimension:          | height                              |

#### Tank/drain body

|                                |       |
|--------------------------------|-------|
| Pressure pipe connection (DN): | 32    |
| Pressure pipe connection (OD): | 40 mm |
| Inlet nominal size (DN):       | 50 mm |
| Pumping volume:                | 7 l   |
| Tank volume:                   | 26 l  |

#### Coverage features

|                       |                      |
|-----------------------|----------------------|
| Type of cover:        | tileable cover plate |
| Cover material:       | Polymer              |
| Colour of cover:      | silver grey          |
| Width of cover:       | 366 mm               |
| Length of cover:      | 366 mm               |
| Locking:              | Lock & Lift          |
| Load class:           | K 3 (EN 1253-1)      |
| Max. flooring height: | 16 mm                |

#### Pumping device

|  |                                |
|--|--------------------------------|
| Pump:  | KTP 300 resistant              |
| Number of pumps:                                   | 1                              |
| Weight, pump:                                      | 4 kg                           |
| Connection type:                                   | Schuko (earthed contact) 2-pin |
| Rated current:                                     | 1,6 A                          |
| Protection class:                                  | I                              |
| Insulation class:                                  | F                              |
| Protection class (pump):                           | IP 68 (3m)                     |
| Temperature monitoring:                            | integrated                     |
| Max. temperature (permanent) of conveyed material: | 40 °C                          |
| Hot water resistance for a short time (2 min):     | 80 °C                          |
| Max. pumping capacity:                             | 8 m <sup>3</sup> /h            |
| Max. pumping height:                               | 6 m                            |
| Speed:   | 2800 U/min                     |
| Power P1:  | 0,34 kW                        |
| Power P2:  | 0,21 kW                        |
| Operating mode:                                    | S1                             |
| Type of fuse required (electrical protection):     | C 16 A                         |
| Type of pump connection cable:                     | H07RN-F 3G 1.5 mm <sup>2</sup> |
| Impeller type:                                     | Multi-vane impeller            |

|  |                                |
|--|--------------------------------|
| Free passage:                                  | 10 mm                          |
| Length of mains cable for pump:                | 5 m                            |
| Control  |                                |
| Motor protection switch:                       | yes                            |
| Level measurement instrument:                  | Float switch                   |
| Type of level measurement:                     | mechanical                     |
| Mains frequency:                               | 50 Hz                          |
| Operating voltage:                             | 230 V                          |
| Connection type:                               | Schuko (earthed contact) 2-pin |
| Type of fuse required (electrical protection): | C 16 A                         |